

147 conveyor

In acciaio. Per convogliare il fascio luminoso in un' unica direzione. Può essere installato con l'acc. 111.

Download

- DXF 2D  
- 147.dxf
- Montaggi  
- acc\_147\_8.pdf

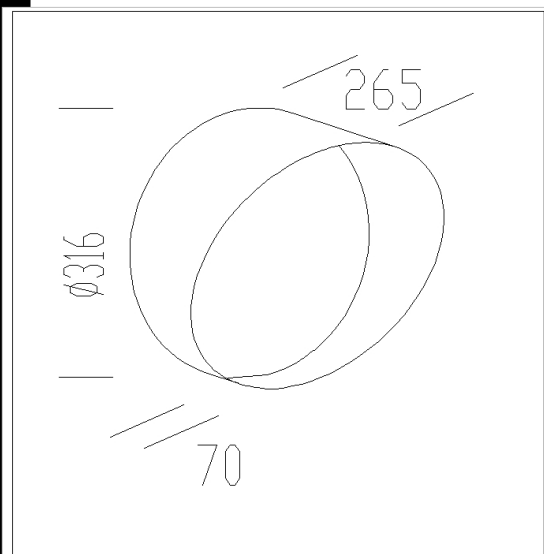
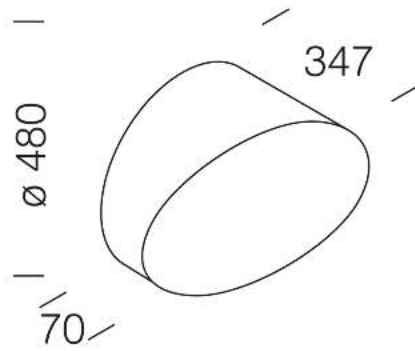

Code	Kg	WTot	Colour
995735-00	0.58	0 W	BLACK

Products



- 1147 Star - narrow beam



- 1147 Star - wide beam

The reported luminous flux is the flux emitted by the light source with a tolerance of  $\pm 10\%$  compared to the indicated value. The W tot column indicates the total wattage absorbed by the system without exceeding 10% of the indicated