

1606 Box 1 - diffuser in scored matt polycarbonate

Housing: Rectangular in f.g. nylon, grey (RAL 7035), vandal-resistant, UV-stabilized.

Frame: In UV-stabilized ASA, grey (RAL 7045)

Diffuser: In vandal-resistant, V2 self-extinguishing polycarbonate, UV-stabilized

Reflector: in bright white vandal resistant, V2 self-extinguishing, UV-stabilized polycarbonate

Lampholder: In polycarbonate, with phosphor bronze contacts

Electric gear: 230V/50Hz power supply. Hard wire, 0.50 sqmm cross-section. 2P terminal block with maximum allowed lead cross-section of 2.5 sqmm.

Equipment: Rubber gasket. With polycarbonate gear tray

Regulations: Produced according to applicable EN60598-CEI 34-21 standards, IP65IK08 degree of protection according to EN 60529 standards. This product can be installed on normally inflammable surfaces. Double insulation class.

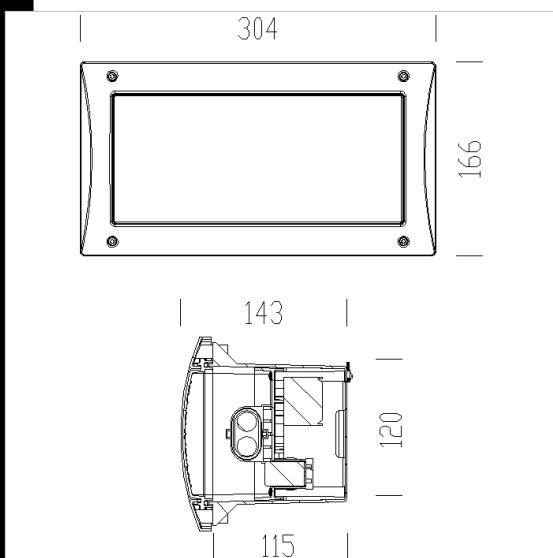

Code	Gear	Kg	Watt	Base	Lamps	Colour
431630-00	CELL	1,47	FLC 1x18L	2G11	1200lm-4000K-Ra 1b	GREY
431630-08	CELL	1,07	FLC 1x18L	2G11	1200lm-4000K-Ra 1b	GREY

Download

DXF 2D
- d1606.dxf

Montaggi
- box1.dxf
- box 1.pdf