

385 pole connector 1x

Steel. To be used in the head-pole solution to create a mono-lamp composition. To be used with an arm access. 386

Download

- DXF 2D
- 385.dxf
- 3DS
- disano_385.3ds
- 3DM
- disano_385.3dm

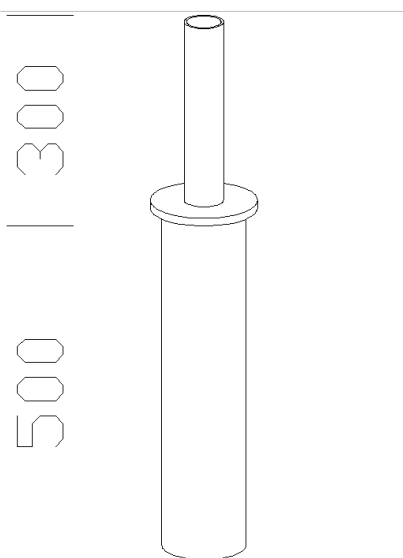
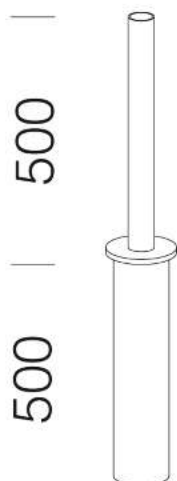

Code	Kg	WTot	Colour
326515-00	6.00	0 W	GREY9007

Products



The reported luminous flux is the flux emitted by the light source with a tolerance of $\pm 10\%$ compared to the indicated value. The W tot column indicates the total wattage absorbed by the system without exceeding 10% of the indicated