

Matrix B5 AR111 LED - 220-240V

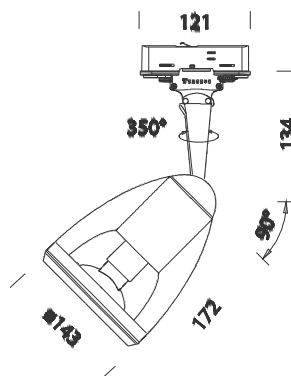

Code	Gear	Kg	Colour	Dimensions	W Tot	lamp
22100812-00	CLD CELL-F	1.60	white	143x143x340 Ø143	11	AR111 LED-GU10-550lm-3000K - 45000h - 25°-Ra 82
22100832-00	CLD CELL-F	1.60	black	143x143x340 Ø143	11	AR111 LED-GU10-550lm-3000K - 45000h - 25°-Ra 82
22100872-00	CLD CELL-F	1.60	met. silver	143x143x340 Ø143	11	AR111 LED-GU10-550lm-3000K - 45000h - 25°-Ra 82

Housing: In die-cast aluminium with central shaft to carry cables.

Coating: with a UV-stabilised powder acrylic-resin paint

Equipment: Supplied with an aiming bar .

Regulations: Manufactured in accordance with EN 60598-1-CEI 34.21 standards. Degree of protection in accordance with EN60529 standards

LED AR111: 230V - 550lm - 3000K - CRI 80 - 25° - 45000h