

## 990 Steel T8 - steel+glass

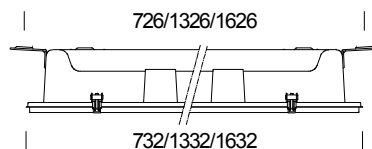
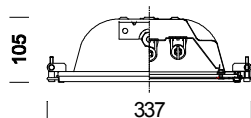

Code	Gear	Kg	Colour	Dimensions	lamp
162151-09	CEL-E	6.90	grey	732x317x105	FL 2x18-G13-1350lm-4000K-Ra 1b
162152-09	CEL-E	11.80	grey	1332x317x105	FL 2x36-G13-3350lm-4000K-Ra 1b
162153-09	CEL-E	15.90	grey	1632x317x105	FL 2x58-G13-5200lm-4000K-Ra 1b
162154-09	CEL-E	8.00	grey	732x317x105	FL 3x18-G13-1350lm-4000K-Ra 1b
162155-09	CEL-E	12.90	grey	1332x317x105	FL 3x36-G13-3350lm-4000K-Ra 1b
162156-09	CEL-E	17.20	grey	1632x317x105	FL 3x58-G13-5200lm-4000K-Ra 1b
162151-08	CEL-F	6.70	grey	732x317x105	FL 2x18-G13-1350lm-4000K-Ra 1b
162152-08	CEL-F	11.40	grey	1332x317x105	FL 2x36-G13-3350lm-4000K-Ra 1b
162153-08	CEL-F	15.50	grey	1632x317x105	FL 2x58-G13-5200lm-4000K-Ra 1b
162155-08	CEL-F	12.30	grey	1332x317x105	FL 3x36-G13-3350lm-4000K-Ra 1b
162156-08	CEL-F	17.00	grey	1632x317x105	FL 3x58-G13-5200lm-4000K-Ra 1b
162152-12	CEL-D	11.40	grey	1332x317x105	FL 2x36-G13-3350lm-4000K-Ra 1b
162153-12	CEL-D	14.00	grey	1632x317x105	FL 2x58-G13-5200lm-4000K-Ra 1b
162155-12	CEL-D	12.30	grey	1332x317x105	FL 3x36-G13-3350lm-4000K-Ra 1b
162154-08	CEL-F	7.80	grey	732x317x105	FL 3x18-G13-1350lm-4000K-Ra 1b
162451-12	CEL-D	6.70	grey	732x317x105	FL 2x18-G13-1350lm-4000K-Ra 1b
162154-12	CEL-D	7.80	grey	732x317x105	FL 3x18-G13-1350lm-4000K-Ra 1b
162156-12	CEL-D	15.00	grey	1632x317x105	FL 3x58-G13-5200lm-4000K-Ra 1b

Housing: In pressed steel drawn in a single piece with high mechanical resistance. Complete with frame.

Reflector: In 2 micron thick, high-gloss, anodized aluminium, exceptional crosswise dimensions for high efficiency.

Painting: In polyester powder, RAL 7035 colour, upon phosphate treatment, resistant to corrosion and salty environments.

Lampholder: In polycarbonate, with contacts in phosphor bronze.

Electric gear: 230-240V/50Hz power supply. Hard wire 0.50 sqmm cross section, PVC-HT sheath, resistant up to 90° according to CEI 20-20 standards. 2P+T terminal block and max allowed lead cross section of 2.5 sqmm.

Equipment: 6.3 A protective fuse. Silicone rubber gasket. Fibreglass nylon cable gland Ø 1/2 gas thread. Complete with ceiling mounting brackets. When opened, the frame remains attached to the housing for easy maintenance

Regulations: Produced according to applicable EN60598-1 CEI 34-21 standards, IP65IK08 degree of protection according to EN 60529 standards. It has been granted the ENEC European Certificate of Conformity. Can be installed on normally inflammable surfaces.

Additional gear: Electronic ballast and emergency kit.

Emergency version: In the event of a blackout, one lamp connected to the emergency circuit remains on, thus avoiding the inconvenience usually caused by sudden power failure. Its emergency run time is 60 minutes. When power supply is restored, the battery recharges automatically.

N.B.: Versions FL2/3x18 with quick plug-socket connector are available on request.

On request FL Extreme lamps available (Working life approximately 60.000)